

INDUSTRIAL NUT CORP.

DOMESTIC MANUFACTURER SINCE 1908



NYLON INSERT LOCKNUTS

WWW.INDUSTRIALNUT.COM

The infinite adjustment inherent in this style of locknut, combined with the low bearing surface runout, ensure proper axial loading for demanding applications. Locking effectiveness is maintained at temperatures up to 250 degree Fahrenheit thanks to the resiliency and "elastic memory" characteristics of the heat-stabilized Type 6/6 nylon insert components. The molded, triple radius design of the insert, makes it easy to install and withstand severe vibration while providing a leak resistant seal between mating parts.

NE SERIES

LIGHT HEXAGON

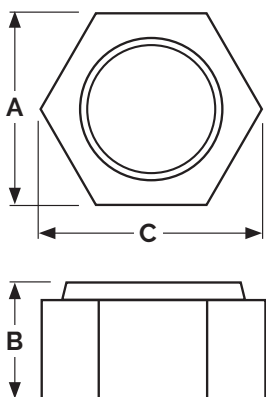

THREAD SIZE	NOMINAL HEX SIZE	MEAN THICKNESS	WIDTH ACROSS CORNERS (REF)	WEIGHT (LBS.)
Class 2B or 3B	A	B	C	per 100 pcs.
0.750-10 UNC	1.062	0.875	1.191	12
0.750-16 UNF				
0.875-9 UNC	1.250	0.984	1.403	19
0.875-14 UNF				
1.00-8 UNC	1.437	1.047	1.615	29
1.00-14 UNF				
1.125-7 UNC	1.625	1.172	1.826	42
1.125-12 UNF				
1.250-7 UNC	1.812	1.391	2.038	60
1.250-12 UNF				
1.375-6 UNC	2.000	1.578	2.249	97
1.375-12 UNF				
1.500-6 UNC	2.187	1.609	2.416	125
1.500-12 UNF				

NU SERIES

HEAVY HEXAGON

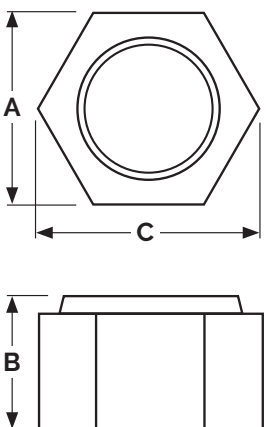

THREAD SIZE	NOMINAL HEX SIZE	MEAN THICKNESS	WIDTH ACROSS CORNERS (REF)	WEIGHT (LBS.)
Class 2B or 3B	A	B	C	per 100 pcs.
1.000-8 UNC	1.625	1.281	1.796	48
1.000-14 UNF				
1.125-7 UNC	1.812	1.438	2.002	70
1.125-8 UN				
1.125-12 UNF	2.000	1.641	2.209	92
1.250-7 UNC				
1.250-8 UN	2.187	1.797	2.416	120
1.250-12 UNF				
1.375-6 UNC	2.375	1.922	2.622	150
1.375-8 UN				
1.375-12 UNF	2.750	2.313	3.035	240
1.500-6 UNC				
1.500-8 UN	2.925	2.359	3.242	295
1.500-12 UNF				
1.750-5 UNC	3.125	2.406	3.449	310
1.750-8 UN				
1.750-12 UNF	3.500	2.813	3.862	400
1.875-5 UNC				
1.875-8 UN	4.000	3.141	4.618	682
1.875-12 UNF				
2.000-4.5 UNC	4.000	3.141	4.618	640
2.000-8 UN				
2.000-12 UNF	4.500	3.641	5.102	950
2.250-4.5 UNC				
2.250-8 UN				
2.250-12 UNF				
2.500-4 UNC				
2.500-8 UN				
2.500-12 UNF				
2.750-4 UNC				
2.750-8 UN				
2.750-12 UNF				
3.000-4 UNC				
3.000-8 UN				
3.000-12 UNF				

We manufacture nylon insert locknuts per the tables shown below or to any custom dimensions which you might require. The nylon insert locknut features predictable torque performance and is less subject to thread galling. Parts come in metric thread sizes from M20 through M150 or the inch equivalent. The blue insert is a trademark of Industrial Nut Corp. making all parts fully traceable from the raw material to finished product.

NTE SERIES

LIGHT HEXAGON, THIN

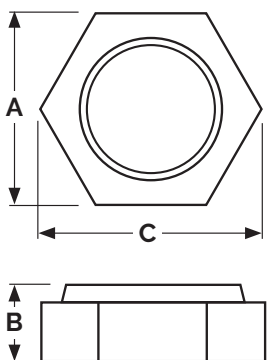

THREAD SIZE	NOMINAL HEX SIZE	MEAN THICKNESS	WIDTH ACROSS CORNERS (REF)	WEIGHT (LBS.)
Class 2B or 3B	A	B	C	per 100 pcs.
0.750-10 UNC	1.062	0.406	1.191	5
0.750-16 UNF				
0.875-9 UNC	1.250	0.469	1.403	8
0.875-14 UNF				
1.00-8 UNC	1.437	0.547	1.615	14
1.00-14 UNF				
1.125-7 UNC	1.625	0.641	1.826	19
1.125-12 UNF				
1.250-7 UNC	1.812	0.734	2.038	26
1.250-12 UNF				
1.375-6 UNC	2.000	0.790	2.249	33
1.375-12 UNF				
1.500-6 UNC	2.187	0.797	2.416	43
1.500-12 UNF				

NTU SERIES

HEAVY HEXAGON, THIN

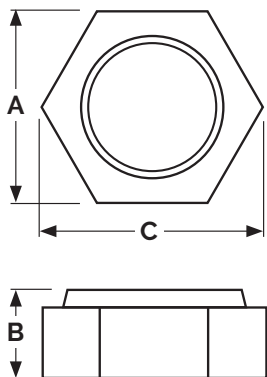

THREAD SIZE	NOMINAL HEX SIZE	MEAN THICKNESS	WIDTH ACROSS CORNERS (REF)	WEIGHT (LBS.)
Class 2B or 3B	A	B	C	per 100 pcs.
1.000-8 UNC	1.625	0.891	1.796	30
1.000-14 UNF				
1.125-7 UNC	1.812	0.969	2.002	47
1.125-8 UN				
1.125-12 UNF				
1.250-7 UNC	2.000	1.109	2.209	57
1.250-8 UN				
1.250-12 UNF				
1.375-6 UNC	2.187	1.188	2.416	70
1.375-8 UN				
1.375-12 UNF				
1.500-6 UNC	2.375	1.313	2.622	95
1.500-8 UN				
1.500-12 UNF				
1.750-5 UNC	2.750	1.469	3.035	140
1.750-8 UN				
1.750-12 UNF				
2.000-4.5 UNC	3.125	1.672	3.449	210
2.000-8 UN				
2.000-12 UNF				
2.250-4.5 UNC	3.500	1.938	3.862	290
2.250-8 UN				
2.250-12 UNF				
2.500-4 UNC	4.000	2.187	4.618	430
2.500-8 UN				
2.500-12 UNF				
2.750-4 UNC	4.000	2.187	4.618	400
2.750-8 UN				
2.750-12 UNF				
3.000-4 UNC	4.500	2.725	5.102	620
3.000-8 UN				
3.000-12 UNF				

DOMESTIC MANUFACTURER SINCE 1908

As an engineering based company, Industrial Nut Corp. has been a leading supplier of self-locking nuts to print for a variety of industries, including heavy truck, construction equipment, farm machinery, mining, and piston rod nuts for the hydraulic cylinder industry.

Produced from forgings, castings, as well as carbon, alloy, and stainless steel bars, our self-locking nuts are ideal for use in high temperature applications. Featuring .005 inch (.125mm) or better perpendicularity between bearing surface and the thread pitch diameter, we manufacture a wide variety of locknut types.

At Industrial Nut Corp., we offer a variety of finish options, as well as additional services, in pre-applied adhesives, special heat treating and plating. All are available upon request, and help to further ensure the high-quality and durability of all our locknut products in their respective applications. As a leading manufacturer of high quality locknuts to print, we invite you to contact our company today for more information.



INDUSTRIAL NUT CORP.

1425 TIFFIN AVE. • SANDUSKY, OHIO 44870 • 419.625.8543 • SALES@INDUSTRIALNUT.COM
WWW.INDUSTRIALNUT.COM